

RESERVE AT GOLDEN ACRES PHASE 5

A SUBDIVISION OF A PORTION OF THE SOUTHEAST 1/4 OF SECTION 17,
TOWNSHIP 25 SOUTH, RANGE 17 EAST, PASCO COUNTY, FLORIDA.

ASSUMED

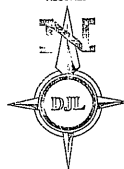

SCALE IN FEET

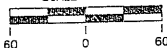

LINE	BEARING	DISTANCE
L1	N17°14'26"W	50.69'
L2	N17°14'12"W	70.85'
L3	N04°40'01"W	22.34'
L4	N04°40'01"W	30.77'
L5	N07°11'27"W	41.80'
L6	N55°08'23"W	4.56'
L7	N55°08'23"W	30.52'
L8	N07°11'50"W	60.67'
L9	S69°54'26"W	80.51'
L10	S84°27'19"W	5.10'
L11	N17°14'26"W	53.69'
L12	N38°48'01"W	67.89'
L13	S04°40'01"W	22.54'
L14	N04°40'01"W	36.52'
L15	N50°11'27"W	56.00'
L16	N65°08'23"W	16.64'
L17	N65°08'23"W	31.22'
L18	N07°11'50"W	70.86'
L19	S69°54'26"W	63.99'
L20	N07°11'50"W	79.33'
L21	N72°41'52"E	45.53'
L22	N58°10'48"E	37.26'
L23	N58°10'48"E	18.01'
L24	N63°09'01"E	62.43'
L25	S73°44'05"E	50.89'
L26	S73°44'05"E	7.17'
L27	N70°30'34"E	66.53'
L28	N73°57'09"E	72.35'
L29	N65°48'42"E	79.38'
L30	N72°47'32"E	51.78'
L31	N58°16'48"E	32.28'
L32	N58°16'48"E	23.13'
L33	N63°09'01"E	51.89'
L34	S72°44'05"E	51.74'
L35	S70°34'10"E	3.16'
L36	N70°30'34"E	73.28'
L37	N73°57'09"E	64.28'
L38	N52°13'20"W	41.60'
L39	N33°34'05"W	50.93'
L40	N12°22'43"E	52.11'
L41	N27°42'51"E	0.50'
L42	N52°13'20"W	31.50'
L43	N33°34'05"W	33.55'
L44	N12°22'43"E	34.20'
L45	N53°56'18"E	0.66'

ABBREVIATIONS

P.B. = PLAT BOOK
F.S.S. = PAGES
NO. = NUMBER
N/N = NO NUMBER
(R) = RADIAL
(NR) = NOT RADIAL
O/A = OVERALL
W/C = WITNESS CORNER
P.O.B. = POINT OF BEGINNING
P.R.M. = PERMANENT REFERENCE MONUMENT
P.S.M. = PROFESSIONAL SURVEYOR & MAPPER

CURVE	RADIUS	ARC	DELTA	TANGENT	CHORD	CHORD BEARING
C1	325.00'	231.34'	40°47'00"	120.81'	226.48'	S09°23'30"W
C2	475.00'	42.17'	08°09'14"	21.10'	42.15'	S08°27'23"E
C3	225.00'	38.45'	08°22'46"	29.26'	58.42'	S07°43'37"E
C4	475.00'	188.04'	21°43'00"	91.11'	178.98'	S10°22'30"E
C5	200.00'	189.51'	21°43'00"	95.91'	188.38'	N10°23'30"W
C6	590.00'	35.57'	06°22'46"	27.88'	55.64'	N02°43'23"W
C7	525.00'	151.20'	16°30'03"	76.12'	150.67'	S12°59'58"E
C8	525.00'	31.89'	03°27'31"	15.85'	31.89'	S10°11'15"E
C9	525.00'	118.51'	13°02'35"	60.01'	119.25'	S11°16'15"E
C10	15.00'	36.96'	84°47'03"	22.82'	33.71'	S47°08'29"E
C11	275.00'	85.23'	17°58'00"	43.47'	85.38'	N61°29'00"E
C12	300.00'	84.07'	17°58'00"	47.43'	93.69'	S81°29'00"W
C13	25.00'	21.03'	48°11'20"	11.18'	20.41'	N48°54'20"E
C14	50.00'	58.90'	67°33'49"	31.47'	55.43'	N58°06'40"E
C15	50.00'	74.18'	85°05'54"	45.82'	67.58'	S45°35'19"E
C16	50.00'	86.38'	79°30'06"	41.58'	63.95'	S35°59'45"W
C17	50.00'	38.84'	44°16'31"	20.34'	37.68'	N81°26'55"W
C18	50.00'	241.19'	27°22'40"	66.67'	117.30'00"	
C19	25.00'	21.03'	48°11'20"	11.18'	20.41'	N48°54'20"E
C20	325.00'	101.92'	17°58'00"	51.38'	101.50'	S81°29'00"W
C21	325.00'	51.82'	08°09'05"	25.95'	51.78'	S77°04'03"W
C22	325.00'	50.00'	08°49'55"	25.10'	50.05'	S88°03'02"E
C23	325.00'	42.05'	08°22'46"	27.95'	37.27'	S42°16'37"W
C24	325.00'	63.65'	11°13'16"	31.33'	63.55'	S05°23'22"E
C25	325.00'	26.38'	04°30'05"	13.00'	26.38'	S02°32'48"W
C26	325.00'	25.28'	04°27'25"	12.85'	25.28'	S18°18'54"W
C27	325.00'	46.74'	08°14'24"	23.41'	46.70'	S25°39'46"W

GENERAL NOTES

- INDICATES FOUND PERMANENT REFERENCE MONUMENT (P.S.M. NO. 2689) UNLESS OTHERWISE SHOWN.
- INDICATES SET PERMANENT REFERENCE MONUMENT (P.S.M. NO. 2689).
- INDICATES SET PERMANENT CONTROL POINT (P.S.M. NO. 2689).
- INDICATES SET 1/2" IRON ROD (L.B. NO. 5789).
- EASEMENTS ARE SHOWN THUS WITH SIZE AND TYPE AS NOTED.
- ALL MEASUREMENTS ARE MADE TO THE NEAREST 1/10 OF A FOOT.
- TRACT "F", ALL OPEN SPACE, DRAINAGE AREAS, RETENTION AND DETENTION PONDS, RECREATION AREAS, BUFFER AREAS, AND PRESERVATION AREAS ARE CONVEYED TO THE RESERVE AT GOLDEN ACRES HOMEOWNERS ASSOCIATION FOR ALL MAINTENANCE RESPONSIBILITIES.
- WITHIN THE PRESERVATION AREAS, THERE SHALL BE NO CONSTRUCTION, CLEARING, FILLING OR IMPROVEMENTS OF ANY KIND UNLESS APPROPRIATE PERMITS HAVE BEEN OBTAINED TO ALLOW FOR WETLAND ENCROACHMENT.
- THERE MAY BE ADDITIONAL RESTRICTIONS THAT ARE NOT RECORDED ON THIS PLAT THAT MAY BE FOUND IN THE PUBLIC RECORDS OF PASCO COUNTY, FLORIDA.
- BEARINGS SHOWN HEREON ARE BASED ON AN ASSUMED BEARING OF N89°37'09"W, BEING THE SOUTH BOUNDARY LINE OF THE SOUTHEAST 1/4 OF SECTION 17, TOWNSHIP 25 SOUTH, RANGE 17 EAST, PASCO COUNTY, FLORIDA, AND OFFER FROM THE BEARING MERIDIAN OF PASCO GLOBAL POSITIONING CONTROL STATIONS N12-039 AND N12-040 BY 0047°50'.
- THE COORDINATE VALUES SHOWN HEREON ARE BASED ON THE PASCO PRIMARY HORIZONTAL CONTROL NETWORK (1983 DATUM) AND WERE ESTABLISHED TO THIRD-ORDER CLASS 1 ACCURACY AS DEFINED BY THE FEDERAL GEODETIC CONTROL COMMITTEE, DATED SEPTEMBER 1984 OR LATEST EDITION.
- THIS PLAT, AS RECORDED IN ITS GRAPHIC FORM, IS THE OFFICIAL DEPICTION OF THE SUBDIVIDED LANDS DESCRIBED HEREIN AND WILL IN NO CIRCUMSTANCES BE SUPPLANTED IN AUTHORITY BY ANY OTHER GRAPHIC OR DIGITAL FORM OF THIS PLAT.

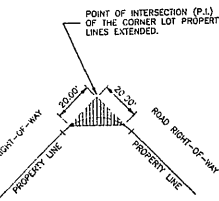

TYPICAL CLEAR SIGHT TRIANGLE
FOR ALL CORNER LOTS

NOT TO SCALE

SHEET 2 OF 2 SHEETS

DJL SURVEYING COMPANY, INC.
8324 CORPORATE WAY (P.O. BOX 791)
NEW PORT RICHEY, FLORIDA 34653